

of the second part, his heirs, executors, administrators and assigns
that he had not made, committed, executed or suffered,
any act or acts, thing or things, whatsoever, whereby or by means
whereof the said premises, or any part or parcel thereof, now was
or at any time hereafter shall, or may, be disseised, charged
or incumbered, in any manner or way whatsoever.

Witness whereof, the said party of the first part, hath here-
unto set his hand and seal the day and year first above written
Signed, sealed and Delivered } W. Stewart. Seal
in the presence of J. H. Cotton

State of California)
County of Colusa) On this 30th day of July in the
year Eighteen hundred and seventy eight before me
J. H. Cotton a Notary Public, personally appeared Robert
Stewart, known to me to be the person whose name
is subscribed to the within instrument, and acknowledged
to me that he executed the same. In witness
whereof, I have hereunto set my hand and official my
office seal at my office in the said County of Colusa
the day and year in the Certificate first above written.
J. H. Cotton
Notary Public

Recorded at the request of Mr. Carpenter Sept. 10th 1878
at 30 min. past 2 o'clock P.M. 370-5-7

Messrs. C. Fisher,
James Reid Stewart,
James Blair Fisher,
James King,
Wm. Stewart,
Merchant and James King,
all of Glasgow in
the United Kingdom of Great Britain and Ireland
of the second part, Merchants, That the said part

This Indenture sheweth the several ways
of March, One Thousand Eight Hundred
and seventy seven. Between
Morton Great Fisher of London
England, of the first part, and James
Merchant and James King, all of Glasgow in
the United Kingdom of Great Britain and Ireland
of the second part, Merchants, That the said part

3-1-77

five Dollars lawful money of the United States of America to him in hand paid by the said parties of the second part, at & before the making and delivery of this present receipt whereby is hereby acknowledged that granted, bargained and sold, and by these presents each granted, bargained and sold, unto the said parties of the second part, and to the survivors and survivors of them, his heirs, and assigns, as joint tenants and not as tenants in common. All those certain tracts of land or parcels of land situate lying and being, in Tehama County San Joaquin County in the State of California particularly described as follows viz. In Township 1 (one) North Range (5) East those portions of sections 12 (twelve) 13 (thirteen) 14 (fourteen) 20 (twenty two) 21 (twenty one) 22 (twenty two) 23 (thirty four) lying South and East of the line constructed along High Ridge and Dicks Slough from that branch of the San Joaquin River known as Tunnel Cut off to Middle River, also the whole of section 22 (twenty four) 25 (thirty five) 26 (thirty six) 28 (thirty eight) and 36 (thirty six) together with the said Tunnel and the land on which it is situated. Fractional South East quarter of section 21 (thirty four) excepted. In Township 1 (one) North Range 5 (five) East those portions of sections 11 (one) 21 (one) and 22 (two) lying East of the Middle River fractional North half and East half of South East quarter of section 22 (thirteen) and also the North East quarter of the North East quarter of section 24 (twenty four) In Township 1 (one) North Range 6 (six) East. Fractional West half of section 17 (seventeen) fractional West half of section 18 (eighteen) South half North West quarter West half of North East quarter and South East quarter of North East quarter of section 19 (nineteen) West half and South West quarter of section 20 (twenty) North half and South West quarter of section 21 (twenty one) whole sections 22 (thirty) and 23 (thirty)

quarter of section 22 (thirty two). On Township 1 south Range
 6 west. Both West quarter of said section both half South
 and quarter and West half of said section of section 6
 West half and West half of the half of section 1 West
 half of West half of section 17 (nineteen) section 18 (eighteen)
 three portions of section 19 (twenty) and of the West half of the
 West half of section 20 (twenty) lying North of the Precinct
 North line. All being of the said Diablo bar and
 jurisdiction according to the United States Survey
 Together with all and singular the premises hereditaments and
 appurtenances thereto belonging, as is anywhere appertaining,
 and the reversion and remainder, and remainders, parts
 issue and profits thereof. And all the estate, right, title,
 interest, property, possession, claim and demand whatsoever as
 well in law as in equity of the said party of the first part,
 of, in or to the above described premises and every part and
 parcel thereof with the appurtenances. To have and to hold
 all and singular, the above mentioned and described prem-
 ises, together with the appurtenances, unto the said parties
 of the second part their heirs and assigns forever, and
 joint tenants as of record. In witness whereof, the said
 party of the first part hath hereunto set his hand and
 seal, this day and year first above written
 Signed, sealed and delivered } Joseph C. Fisher. (Seal)
 in presence of }
 John J. O'Connell }
 John J. O'Connell }
 County of San Francisco }
 September, in the year of Our Thousand Eight
 Hundred and Ninety Seven before me, Edw. Jones
 a Notary Public, in and for said City and County
 personally appeared Nelson C. Fisher known
 one to be the person named and verified in the within
 as subscribed to the within instrument, and he acknowledged
 to me that he executed the same for the purposes
 and objects therein expressed.

Recorded at request of Ed. W. Fisher Deputy N. J. 1897 at 20 minutes past 9 to him.

FILE SPEC: P:\1732_SINNOCK\0070_Historical_Mapping\Survey\Wass\Exhibits\CD\VC_MC_Fisher_To James Stewart et al.dwg
 PLOT DATE: Mar 31 2010 - 8:45am

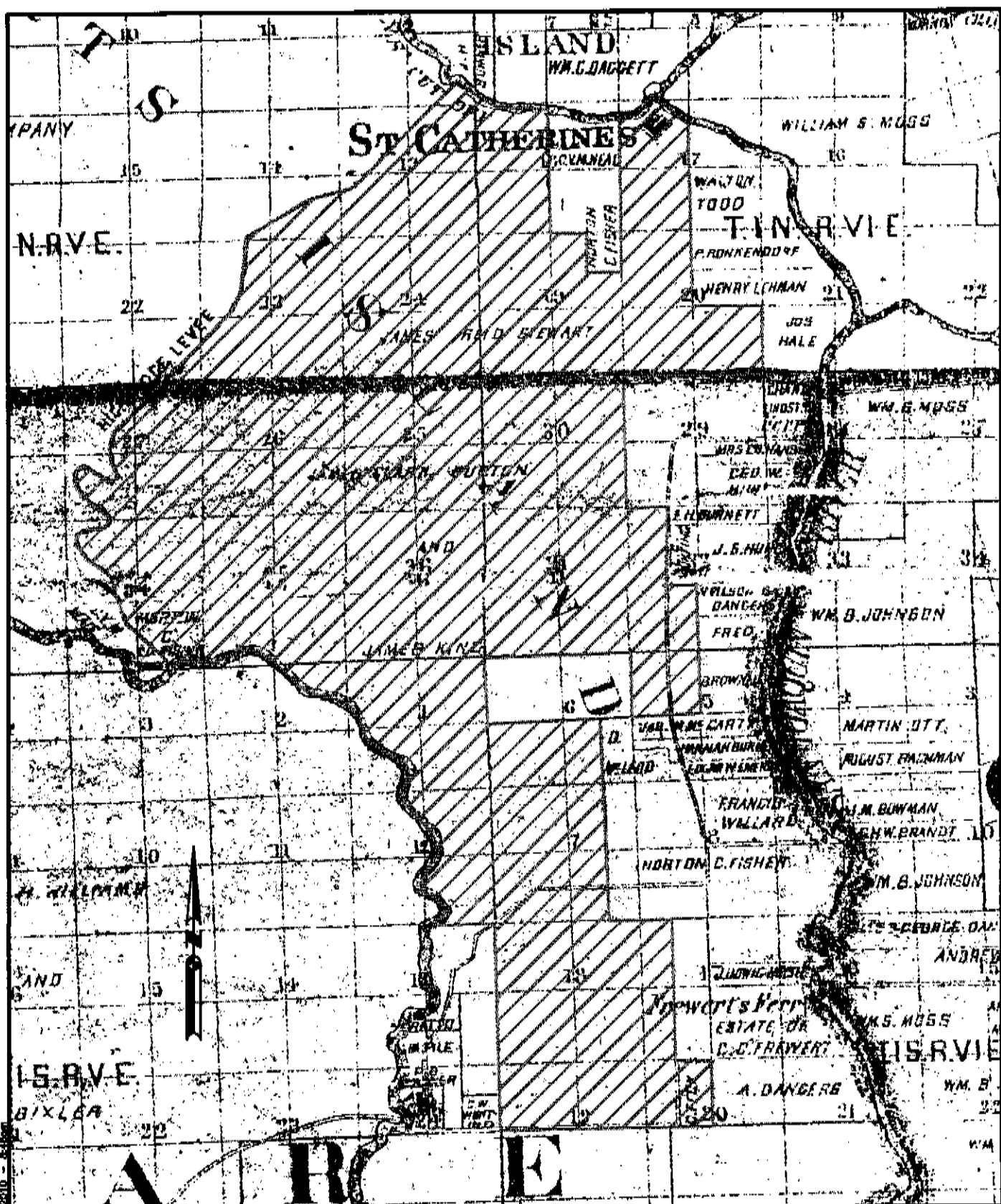

K S N INC.
KJELSEN SINNOCK NEUDECK
 Civil Engineers and Land Surveyors
 Post Office Box 844
 711 N. Parsippany Avenue
 Rockton, CA 95201-0844
 Office: (208) 846-0288
 Fax: (208) 846-0286
 E-mail: KSN@nanina.com

MUSSE CHAIN OF TITLE
GRANTOR: M.C. FISHER
GRANTEE: STEWART ET. AL.
MARCH 15TH, 1877

Design	Scale
Drawn	1" = 5000'
Check	Original Drawing Scale
SLB	0 1/4" 1/2"

Date	03/30/10
Sheet Number	
Of	
Project File No.	1732-0070